

## OWNER'S MANUAL

# XTR-435

# LASER-RADAR DETECTOR

The Whistler Group Corporate Headquarters  
3604 NW Frontage Rd. • Bentonville, AR 72712  
Tel 479.273.6012 • Fax 479.273.2927

### Customer Return Center

551 N 13th St. • Rogers, AR 72756  
Customer Service Tel 800.531.0004

[www.whistlergroup.com](http://www.whistlergroup.com)

P/N 202913, © 2012 The Whistler Group, Inc.



Dear Whistler Detector Owner,  
If you have questions concerning the operation of this Whistler product please call:

**CUSTOMER SERVICE**  
**1-800-531-0004**

Monday - Friday • 8:00 am - 5:00 pm CT  
or visit our website

[www.whistlergroup.com](http://www.whistlergroup.com)

Please keep the receipt in a safe place. You may register your product online at [www.whistlergroup.com](http://www.whistlergroup.com). For warranty verification purposes, a copy of your dated store receipt must accompany any unit sent in for warranty work. If the unit is returned without a dated store receipt, an out of warranty service charge applies.

**Note:** Your warranty period begins at the time of purchase. The warranty is validated only by the dated store receipt! Now is the time to record the serial number of the unit in the space provided in the warranty section of the manual.

To fully acquaint yourself with the operation of your Whistler Detector and to better understand the differences between detecting radar, laser and safety radar signals, we recommend reading this entire manual or visiting our FAQ page on our website [www.whistlergroup.com](http://www.whistlergroup.com)

Enjoy your Whistler Detector and please drive safely.

Sincerely,

The Whistler Group, Inc.

Model Features Summary .....	2-3
Installation .....	4-6
• Mounting Guidelines	4
• Windshield Mounting	5
• Power Connection and Fuse Replacement	6
Operation .....	7-14
• Power On Self Test & Volume	7
• Feature Engaged Confirmation	7
• Dim/Dark Mode	7
• Setting Saver	7
• Quiet/Auto Quiet Mode	8
• Audio Level Adjustment	8
• City/City 1/ City 2 Mode	9
• Highway Mode	9
• Teach/Tutorial Mode	10
• Alert Periscopes	10
• VG-2 Mode	11
• Safety Warning System	11
• Alert Priority	11
• Vehicle Battery Saver Mode	12
• Traffic Flow Signal Rejection (TFSR)	12
• Option Select Mode	13
• Stay Alert Feature	14
POP™ Mode Alerts .....	15
Laser/Radar Alerts .....	15
• Speed Radar Audio/ Visual Alerts	15
• Laser Audio/ Visual Alerts	15
• Pulse Protection®	15
VG-2 Alerts .....	16
Reset Features .....	16
Troubleshooting Guide .....	17
Care and Maintenance .....	18
Are Detectors Legal? .....	18
FCC Information .....	19
Speed Monitoring .....	19-22
• Radar Facts	19
• POP™ Mode	20
• Laser Facts/ Tips	20-21
• Other Speed Detection Systems	21
• Radar Detector Detectors	21-22
Warranty Information .....	22-25
Specifications .....	25
Accessories .....	26

### WHISTLER FEATURES XTR-435

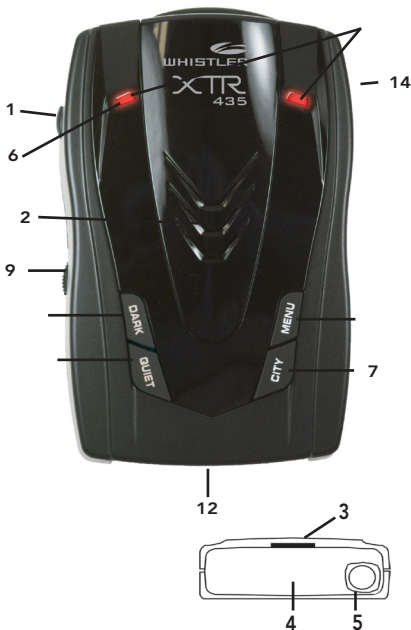

### FEATURE DESCRIPTIONS

Whistler's ergonomic and user-friendly design provides a new level of operating convenience. Special features include:

- 1. Bracket Release Button** – provides quick and easy release of the mounting bracket.
- 2. Speaker** – provides distinct audio warnings for X, K, Ka band radar, Safety Warning System, laser and VG-2.
- 3. Mounting Bracket Location** – slot holds mounting bracket firmly.
- 4. Radar Antenna** – compact, high-efficiency antenna receives radar signals.
- 5. Front Laser** – high gain optical lens provides increased sensitivity and field of view for leading-edge laser detection.
- 6. Rear Laser** – an integrated optical waveguide provides superior detection of laser signals transmitted from behind.
- 7. City Button** - reduces the annoyance of false alerts typically encountered in urban driving areas.
- 8. Quiet Button** - pressing QUIET before a signal is detected engages Auto Quiet Mode which automatically reduces the audio level after the initial warning to a low audio level setting. Pressing QUIET during a radar/laser encounter silences audio alerts, while allowing visual alerts to keep you informed.
- 9. Power / Volume Control** – turns unit on/off and adjusts audio level.
- 10. Dim / Dark Button** - engages Dim/Dark modes.
- 11. Menu Button** - enters Option Select Mode.
- 12. Red OLED Text Display** - provides better contrast, brightness and color/shows alerts detected, signal strength, and indicates engaged modes of operation.
- 13. Alert Periscopes** - provide an additional attention getting visual alert.
- 14. Power Jack** - provides connection for the power cord.

### INSTALLATION

#### Mounting Guidelines

- Mount the unit as low as possible near the center of the windshield.
- Do not mount the unit behind wipers, ornaments, mirrored sunscreens, etc. These obstructions have metal surfaces which can affect radar and laser signals and reduce critical warning time. (Regular tinted glass does not affect reception).
- Some windshields have an Instandclear™ or Electricclear™ type coating, which affect radar signals. Consult your dealer or the vehicle's owner's manual to determine if your windshield has this coating.
- Avoid placing the unit in direct contact with the windshield.
- To reduce the possibility of theft, conceal the unit when not in use.

#### Windshield Mounting

- Install the two suction cups and rubber bumper onto the bracket by fitting them into their holes.
- Press the suction cups onto the windshield at the location you have chosen. (Image A)

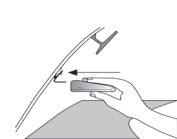

(Image A)

Windshield  
Mounting

**IMPORTANT:** Make sure the unit is level

## INSTALLATION

**Important:** Some newer cars have a plastic safety coating on the inside of the windshield. The windshield bracket may leave permanent marks on this type of surface. To find out if your vehicle has this type of windshield, check the vehicle's owner's manual or ask your dealer. We recommend that you do not leave the suction cup bracket on the windshield in direct sunlight. If the detector is removed, this may cause blistering of the dash in some vehicles.

- Slide the detector onto the bracket until it locks into place. (Image B)

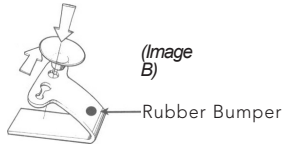

- If necessary, the unit may be leveled by bending the windshield bracket. Press the bracket release button and remove the detector before bending.

5

## INSTALLATION

### Power Cord Connection

- Plug the small end of the power cord into the unit's power jack.
- Plug the large end into the vehicle's cigarette lighter socket.

**Note:** Cord fits tightly into detector. When installing the cord, expect some resistance.



### Fuse Replacement

The lighter socket plug is equipped with a replaceable 2 amp, 3AG fuse located behind the silver tip. To replace the fuse, carefully unscrew the tip of the plug.

**Important:** Unscrew slowly. The tip contains a spring which may fly out when disassembling. Insert the new fuse with the spring and screw on the tip. With use, screw cap on plug may loosen. **Retighten occasionally.**

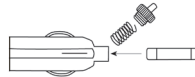

6

## OPERATION

### Power On Self Test

Each time your Whistler detector is turned on, an automatic self-test sequence confirms that the speaker and display is functional along with many of the saved settings.

### Feature Engaged Confirmation

Each time a button is pressed, one beep confirms feature "on", two beeps confirm feature "off".

### Dim/Dark Mode

Dim/Dark Mode reduces the illumination of the display

- Press and release the Dark button to reduce illumination to a dim setting.
- Press and release the Dark button a second time to engage Dark Mode. The display illumination is further reduced.

Dim or Dark can be engaged during an alert. In Dark Mode, the display goes dark for as long as a signal is being detected and 20 seconds after, then the display returns to the dimmer setting.

- Press and release the Dark button a third time to restore the display to full illumination.

### Setting Saver

Setting Saver saves your personalized settings so that when the detector is turned off and then on again, you do not have to re-enter them.

7

## OPERATION

### Quiet Mode

Quiet mode cancels audio during an alert and any new alert within 20 seconds. After 20 seconds, 2 beeps are provided on any new alert and unit then remains quiet.

- Press Quiet button to cancel the audio.
- Press Quiet button a second time during an alert to restore the standard audio alert pattern; or turn the unit off, then on.

### Auto Quiet Mode

Auto Quiet mode provides an alternate alert pattern approximately 5 seconds after a radar or safety warning system signal is detected followed by clicking. The clicking will continue for as long as the detected signal is present and for any new signal within 20 seconds. Auto Quiet mode does not affect laser alerts.

- Press Quiet (before a signal is detected) to engage Auto Quiet mode.
- Press Quiet (when the unit is not alarming) to cancel Auto Quiet mode.

### Audio Level Adjustment

To Change the audio level:

- Rotate Power/Volume button back to increase audio level.
- Rotate Power/Volume button forward to decrease audio level.

8

## OPERATION

### City/City 1/City 2 Mode

Whistler's Three Stage City Mode is designed to reduce the annoyance of automatic door openers, intrusion alarms and other devices which share frequencies with police radar. Generally, X band is used for these devices.

- Press City button to cancel Highway Mode and engage City Mode.
- Press City button again to enter City 1 Mode
- Press City button again to enter City 2 Mode
- Press City button a fourth time to cancel City 2 Mode and return the unit to Highway Mode.

In City Mode, weak speed/safety radar signals give an initial alarm of two beeps, and then remains quiet unless the signal becomes very strong. When the signal strength increases, two additional beeps are provided. City 1 and City 2 Modes operate the same as Highway Mode, but in City 1 Mode, X band requires a stronger signal to alert. In City 2 Mode, X-band is not detected.

**Caution:** Some towns/small cities may still be using X band radar. City Modes do not change the audio alert for laser or VG-2.

9

## OPERATION

### Highway Mode

Highway mode provides full audio warnings any time radar (X, K, Ka, Safety Warning System) or laser signals are detected, and is recommended for open road driving.

For more information on City and Highway modes, please visit our F.A.Q. page on our website: [www.whistlergroup.com](http://www.whistlergroup.com)

### Teach/Tutorial Mode

Provides simulated alerts for each type of signal.

- Press City and Quiet buttons simultaneously

- Display Shows:

**TEACH**

- Press Dark button to exit.

### Alert Periscopes

Whistler's Alert Periscopes provide an added attention getting visual alert. The two extra LED's flash on and off when the unit alarms to provide a unique visual alert. This alert can be programmed through the Option Select Mode to:

- Flash for all alarms
- Remain ON
- Turn LED's OFF completely

10

## OPERATION

### VG-2 Mode

See Option Select Mode to turn this feature on/off. When a VG-2 signal is detected, the VG-2 alert is sounded and the display flashes "VG-2". After 3 seconds the audio is canceled and the display no longer flashes. This cycle is repeated if the VG-2 signal is detected again.

**During the period a VG-2 signal is detected, a radar signal cannot be detected.**

However, because the VG-2 alert has confirmed that a patrol car is nearby, you are already aware of the potential for speed monitoring and can adjust your speed accordingly. Laser detection is not affected while a VG-2 signal is detected. (See page 16 for more information)

### Safety Warning System™

In communities where transmitters are located, the Safety Warning System™ displays over 60 text messages. When Safety Radar is detected, a unique audio alert sounds.

**Safety Warning System Text Example:** Poor - Road - Surface.

**Note:** Not all areas have Safety Warning System™ transmitters.

### Alert Priority

When two or more signals are received at the same time, the alert priority is:

**1. Laser 2. VG-2 3. Speed Radar 4. SWS**

**Example:** If X band is alerting, then suddenly a VG-2 signal is detected, the VG-2 warning will override the X band alert.

11

## OPERATION

### Vehicle Battery Saver Mode

The Vehicle Battery Saver Mode automatically shuts off the detector after 3 hrs. The timer is reset if the detector is turned off, unplugged or any button is pressed before the timer has expired. The detector will alert you with an audible and visual warning before it shuts off. During this warning, you can momentarily reset the timer by pressing any button. If the unit has automatically turned off, press any button to turn the unit back on.

Refer to "Option Select Mode" for instructions for deactivating battery saver mode feature.

### TFSR - Traffic Flow Signal Rejection

When turned on in option mode, helps eliminate excessive alerts from erroneous X and K-band sources. Traffic flow monitoring systems are getting more common. Many of these systems generate radar signals to measure the flow of traffic across multiple lanes. Most detectors will alert you to it unnecessarily. This rejection feature examines the incoming signal and will aid in reducing the alerts to such sources.

We suggest you turn TFSR on if you are experiencing excessive X or K band false alerts every half mile or so along stretches of roadway that contain these traffic flow sensors.

**Note:** Enabling this feature disables K Pop detection (Ka Pop functions normally).

12

## OPERATION

### Option Select Mode

Entering Option Select Mode allows you to customize options such as Tone Select, Abbreviated Power Up Sequence, and VG-2 Mode. Press the Menu button to enter Option Select Mode. When selecting options, the Dark or Quiet buttons must be pressed within 20 seconds or Option Select Mode will automatically be exited.

Press Menu:	Display Shows:	To Change: D=Dark / Q=Quiet	Option:
1st Time	TONE 3	D or Q	Tone 1, 2, 3 (Three Different Tone Patterns)
2nd Time	TEST YES	D = YES Q = OFF	X, K, Ka Audio Tones One Beep During Power Up
3rd Time	VG2 OFF	D = ON Q = OFF	Turns VG-2 On Turns VG-2 Off
4th Time	SWS OFF	D = ON Q = OFF	Turns SWS™ On Turns SWS™ Off
5th Time	POP ON	D = ON Q = OFF	POP On POP Off
6th Time	LED BLINK	D or Q	Dual LED Alert Periscope (ON, OFF, or Blinking)
7th Time	B SVR ON	D = ON Q = OFF	Battery Saver On Battery Saver Off
8th Time	TFSR OFF	D = ON Q = OFF	TFSR On TFSR Off

Press and hold Menu button to exit Option Select Mode.

13

## OPERATION

### Stay Alert Feature

The Stay Alert Feature is designed to test a driver's alertness. To engage (when the unit is not alarming):

- Press and hold the City button for approximately 2 seconds. Release the button during or immediately after the alert is given. Display shows:

**RU ALERT**

Within 30-60 seconds, an alert is sounded; to show alertness, the driver must press either the City, Menu, or Quiet buttons within 3-5 seconds. If a button is pressed within 3-5 seconds, the cycle is repeated.

If a button is not pressed within 3-5 seconds, an alarm sounds and the display shows:

**GET REST**

- Press the Dark button to exit the Stay Alert feature.

**WARNING!!!** Stay Alert is NOT intended as a substitute for adequate rest. You should NOT operate a vehicle if you are drowsy. During extended periods of vehicle operation, you should take frequent breaks. Improper reliance on the Stay Alert feature may result in vehicle damage, personal injury or death.

**NEVER OPERATE A VEHICLE IF YOU ARE DROWSY.**

14

## POP™ MODE ALERTS

### POP™ Mode Alerts

Because POP™ Mode radar utilizes the same K or Ka band frequencies, POP™ Mode Alerts will be displayed as regular radar alerts.

## LASER/RADAR ALERTS

### Speed Radar Audio/Visual Alerts

When X, K, or Ka is detected, the band ID and signal strength is displayed. The audio alert is continuous and has a pattern like a geiger counter. The faster the beep, the closer or stronger the radar source.

### Laser Audio/Visual Alerts

When a laser signal is detected the audio alert is continuous for a minimum of 3 seconds.

The Display Shows:

**LASER** 

### Pulse Protection®

Pulse (or instant-on) radar is more difficult to detect than conventional radar because it remains 'off' until activated to measure the speed of a targeted vehicle.

When a pulse type transmission is detected, your Whistler detector sounds an urgent 3-second audio warning and the display shows:

**PULSE**

After the 3-second pulse alert, the standard alert pattern continues for as long as the signal is present.

It is important to respond promptly to a pulse alert, since warning time may be minimal.

15

## VG-2 ALERTS

### VG-2 Audio/Visual Alerts

**Note:** You must turn this feature on before it will detect VG-2.

When a VG-2 signal is detected, the detector "hides" its own radiated signal and becomes undetectable by the VG-2. Every 30 seconds, the detector checks for a VG-2 signal. If a VG-2 signal is still present, the unit continues to hide and repeats the VG-2 alert. If no signal is detected, two beeps are provided, indicating an "all clear" condition. During a VG-2 Alert X, K, and Ka band signals cannot be received (see pg. 21).

## RESET FEATURES

All user features can be reset to factory settings.

- Unplug the Power Cord from the unit.
- Press and hold the Quiet button.
- Plug the Power Cord into the unit.
- Wait for 2 beeps.
- Release the Quiet button.

**Unit is now reset to the following features and settings.**

**Default factory settings are:**

1. HIGHWAY Mode
2. Dim/Dark Mode to full illumination of display
3. Auto Quiet Mode OFF
4. VG-2 Detection Mode OFF
5. Safety Radar OFF
6. Vehicle Battery Saver ON
7. Full Power Up sequence
8. Default TONE 3
9. POP OFF
10. LED Periscopes to BLINK
11. TFSR OFF

16

## TROUBLESHOOTING

Your Whistler detector is expertly engineered and designed to exacting quality standards to provide you with reliable, trouble-free operation. If your unit has been correctly installed following the guidelines in this manual, but is not operating optimally, please refer to the troubleshooting guide below.

### PROBLEM: No display or audio.

- Check the fuse in the plug; replace if necessary with a 2 amp, 3AG type.
- Check the fuse for lighter socket; replace if necessary.
- Make sure the lighter socket is clean.

### PROBLEM: Unit alarms when vehicle hits bumps.

- Check for a loose lighter socket; tighten and clean.
- Check the connections at both ends of the power cord. Substitute another cord to determine if the cord is defective. Return the defective cord to the factory.

### PROBLEM: Audio alerts are not loud enough.

- Cancel Auto Quiet Mode or City Mode.
- Check audio level setting. (see page 8)

If difficulties occur which cannot be solved by information in this Troubleshooting Guide, please call Whistler Customer Service at 1-800-531-0004 or visit our FAQ page at [www.whistlergroup.com](http://www.whistlergroup.com), before returning your unit for service.

17

## CARE AND MAINTENANCE

### Care And Maintenance

During the summer months, avoid prolonged exposure to direct sunlight by removing your unit from the dash when your vehicle is parked for an extended period of time. Do not spray water, cleaners, or polishes directly onto the unit. The spray may penetrate through the openings and damage the unit. Also, do not use any abrasive cleaners on the unit's exterior.

## ARE DETECTORS LEGAL?

### In Most States YES!

Laser-Radar detectors are legal in every state for automobiles and light trucks (under 10,000 lbs.) except Virginia and Washington, D.C., which have local regulations restricting the use of radar receivers in any vehicle.

The Federal Highway Administration (FHWA) passed a nationwide regulation, effective January 1994, which prohibited radar and laser detector use in vehicles over 10,000 lbs.

18

## FCC INFORMATION

FCC ID : HSXWH10  
FCC ID : HSXWH21

This device complies with part 15 of the FCC Rules. Operation is subject to the following two conditions:

- (1) This device may not cause harmful interference, and
- (2) this device must accept any interference received, including interference that may cause undesired operation.

**Important:** FCC (Federal Communications Commission) requirements state that changes or modifications not expressly approved by Whistler could void the user's authority to operate the equipment.

## SPEED MONITORING

### Radar Facts

A radar gun operates by transmitting radio waves at certain frequencies which reflect off objects and are picked up by the radar gun's receiving section. When a radar beam reflects off a moving target, a measurable frequency shift occurs. The radar unit converts this shift into miles per hour to determine your vehicle's speed. Currently, the FCC permits operation of traffic radar guns at X Band (10.500 - 10.550 GHz), K Band (24.050 - 24.250 GHz), and Ka Band (33.400 - 36.000 GHz).

**Note:** A radar detector will only alarm if an officer is transmitting on any one of the above radar bands.

19

## SPEED MONITORING

### POP™ Mode

POP™ Mode is a feature on some radar guns operating on K and Ka bands. When the gun is in POP™ Mode and activated, a brief burst of energy, less than 1/15 of a second, is transmitted and the vehicle's speed is quickly acquired. A detector without POP™ Mode detection capability cannot respond to this brief transmission.

### Laser Facts

It's well documented that many radar guns cannot reliably provide the speed of a targeted vehicle that is traveling in a group of vehicles. In contrast, a laser gun can target a specific vehicle out of a line of traffic and determine its speed. The advantage of laser over radar in terms of target identification is the result of the laser gun's narrow beam. A radar gun's transmission can cover more than a four-lane highway at a distance of 1,000 feet, compared with a laser gun's transmission which covers about 3 feet at the same distance. For best protection, keep these points in mind:

- Because the vehicle's license plate or headlights are the laser gun's primary targets, mounting the Whistler detector on the dashboard can improve laser detection at short range.
- Do not follow closely behind any vehicle. If you can't see past a vehicle ahead of you, chances are your detector won't either.
- The receiving range of laser signals will not be the same as radar signals. Laser guns are most often used at short range. Whistler Laser-Radar detectors receive all current laser guns which operate at a laser wavelength of 905 +/- 10nm.

20

## SPEED MONITORING

### Laser Tips

If you are the targeted vehicle, a laser gun can often determine your speed within a few seconds after you receive an alert. In this situation, there is generally no time to safely adjust your speed. However, if you are traveling near or behind the targeted vehicle and receive an alert, response time should be sufficient. Any laser alert, regardless of duration, requires immediate action!

### Other Speed Detection Systems

Several techniques other than radar or laser are used to measure vehicle speeds. When these methods are being used, no detector can provide a warning. These techniques include:

- **Pacing** - A patrol car drives behind you and matches your driving speed.
- **Vascar/Aircraft** - The police measure the time it takes your vehicle to travel a known distance.

### Radar Detector Detectors: VG-2, Spectre

The Interceptor VG-2 or simply VG-2, is one type of microwave receiver used by Police to detect signals radiated by the local oscillator of a radar detector. Because its purpose is to identify persons driving with radar detectors, these devices are known as a "radar detector detector" (RDD).

An RDD is the primary tool used by the police to identify radar detector equipped vehicles. If caught in a state or country where detectors are illegal (see page 18), drivers risk losing their radar detector and receiving a fine. In addition, instant-on radar is almost always used in combination with an RDD, leaving unsuspecting motorists vulnerable to receive two tickets - one potential for speeding, and the other for possession of a detector.

21

## SPEED MONITORING

**Note:** Having a radar detector capable of detecting the VG-2 may alert you to the presence of a speed trap. The newest tool Police have to detect radar detectors is called Spectre. Spectre can detect the majority of undetectable (VG-2) laser/radar detectors on the market.

**It is the responsibility of the radar detector user to know and understand the laws in your area regarding the legality of the use of radar detectors.**

## WARRANTY INFORMATION

### Consumer Warranty

This Whistler Laser-Radar detector is warranted to the original purchaser for a period of one year from the date of original purchase against all defects in materials and workmanship. This limited warranty is void if the unit is abused, modified, installed improperly, or if the housing and/or serial numbers have been removed. There are no express warranties covering this product other than those set forth in this warranty. All express or implied warranties for this product are limited to the above time. Whistler is not liable for damages arising from the use, misuse, or operation of this product.

### Service Under Warranty

During the warranty period, defective units will be repaired without charge to the purchaser when returned with a dated store receipt to the address listed in this section.

Units returned without a dated store receipt will be handled as described in section

**"Service Out Of Warranty."**

22

# XTR-435 Owner's Manual

## WARRANTY INFORMATION

Due to the specialized equipment necessary for testing a Laser-Radar receiver, there are no authorized service stations for Whistler brand detectors other than Whistler.

When returning a unit for service, please follow these instructions:

1. Ship the unit in the original carton or in a suitable sturdy equivalent, fully insured, with return receipt requested to:

**Whistler Repair Dept.**  
551 N. 13th St.  
Rogers, AR. 72756

**Please allow 3 weeks turnaround time.**

**Important:** Whistler will not assume responsibility for loss or damage incurred in shipping. Therefore, please ship your unit insured with return receipt requested. **CODs will not be accepted!**

2. Include with your unit the following information, clearly printed:
  - Your name and street address (for shipping via UPS), a daytime telephone number and an email address, if applicable.
  - A detailed description of the problem (e.g., "Unit performs self-test but does not respond to radar").
  - A copy of your dated store receipt or bill of sale.
3. Be certain your unit is returned with its serial number. For reference, please write your unit's serial number in the following space:  
s/n\_\_\_\_\_.

Units without serial numbers are not covered under warranty.

23

## WARRANTY INFORMATION

**Important:** To validate that your unit is within the warranty period, make sure you keep a copy of your dated store receipt. You may register your warranty online at [www.whistlergroup.com](http://www.whistlergroup.com), however, for warranty verification purposes, a copy of your dated store receipt must accompany any unit sent in for warranty work.

### Service Out of Warranty

Units will be repaired at "out of warranty" service rates when:

- The unit's original warranty has expired.
- A dated store receipt is not supplied.
- The unit has been returned without its serial number.
- The unit has been abused, modified, installed improperly, or had its housing removed.

The minimum out of warranty service fee for your Whistler detector is \$55.00 (U.S.). If you require out of warranty service, please return your unit as outlined in the section "Service Under Warranty" along with a certified check or money order for \$55.00. Payment may also be made by MasterCard, VISA or American Express; **personal checks are not accepted.**

**In the event repairs cannot be covered by the minimum \$55.00 service fee, you will be contacted by a Whistler technical service specialist who will outline options available to you.**

If you elect not to have your unit repaired, it will be returned to you along with your certified check or money order.

24

## WARRANTY INFORMATION

**Important:** When returning your unit for service, be certain to include a daytime telephone number and an email address (if applicable).

### Customer Service

If you have questions concerning the operation of your Whistler detector, or require service during or after the warranty period, please call Customer Service at: **1-800-531-0004**

Representatives are available to answer your questions Monday - Friday from 8:00 a.m. to 5:00 p.m. (CT) or visit the FAQ's at [www.whistlergroup.com](http://www.whistlergroup.com).

## SPECIFICATIONS

### Laser Wavelength:

905 ± 50 nanometers (nm)

### Radar Frequencies:

10.500 - 10.550 GHz (X Band)

24.050 - 24.250 GHz (K Band)

33.400 - 36.000 GHz (Ka Superwideband)

### Operating Temperature Range:

-10 C to +70 C (+14 F to +158 F)

### Power Requirements:

Operational 12 to 15 volts DC, 250mA nominal  
Vehicle Battery Saver, 30mA nominal.

### One or more U.S. patents may apply:

#5,666,120, #7,215,276

POP™ Mode is a trademark of MPH Industries, Inc.

SWS™ is a trademark of Safety Warning System L.C.

CE Specifications are subject to change without notice.



25

## ACCESSORIES

The following accessories can be ordered directly from Whistler by calling **1-800-531-0004** or visiting our online store at [www.whistlergroup.com](http://www.whistlergroup.com)

Order #	Description	Price
202151	Windshield Bracket Kit	\$9.95
206552	Straight Power Cord (5)	\$14.95
206880	Hardwire Kit (10' ) (for wiring to fuse box)	\$9.95
206666	Modular* Cord Package (includes coiled and straight cords, and power adapter)	\$17.95
159032	Package of 8 Suction Cups	\$2.95
402080	Non Skid Dash Pad	\$6.95

\* Modular: Interconnecting pieces cord and plug.  
**Shipping and handling (per order) \$5.00 .**

**Prices are subject to change without notice.**

26